

1ST LEVEL ENT. TO HIGH BAY

1ST LEVEL ENT. TO HIGH BAY

**LINE SET**

LS#	DESCRIPTION	DEPTH	TRIM	SOFT GOOD	SIZE
1	WHITE CYC	25"10"	48"0" W X 24"		
2	BLACK TRAVELER	25"10"	48"0" W X 24"		
3	CYC LIGHT	19"6"			
4	3RD BORD	31"0"	48"0" W X 8"0"		
5	1ST LEGS	26"0"	15"0" W X 23"		
6	2ND BORD	31"0"	48"0" W X 5"0"		
7	ADJUSTAB	48"0" W X 11"0"			
8	BORDER	33"9"4"	48"0" W X 11"0"		

**LINE SET SCHEDULE**

SOFT GOOD	DEPTH	TRIM	DESCRIPTION	LS#
48"0" W X 24"	25"10"		WHITE CYC	1
48"0" W X 24"	25"10"		BLACK TRAVELER	2
26"0"			CYC LIGHT	3
48"0" W X 8"0"	31"0"		3RD BORD	4
15"0" W X 23"	26"0"		1ST LEGS	5
48"0" W X 5"0"	31"0"		2ND BORD	6
48"0" W X 11"0"			ADJUSTAB	7
48"0" W X 11"0"	33"9"4"		BORDER	8

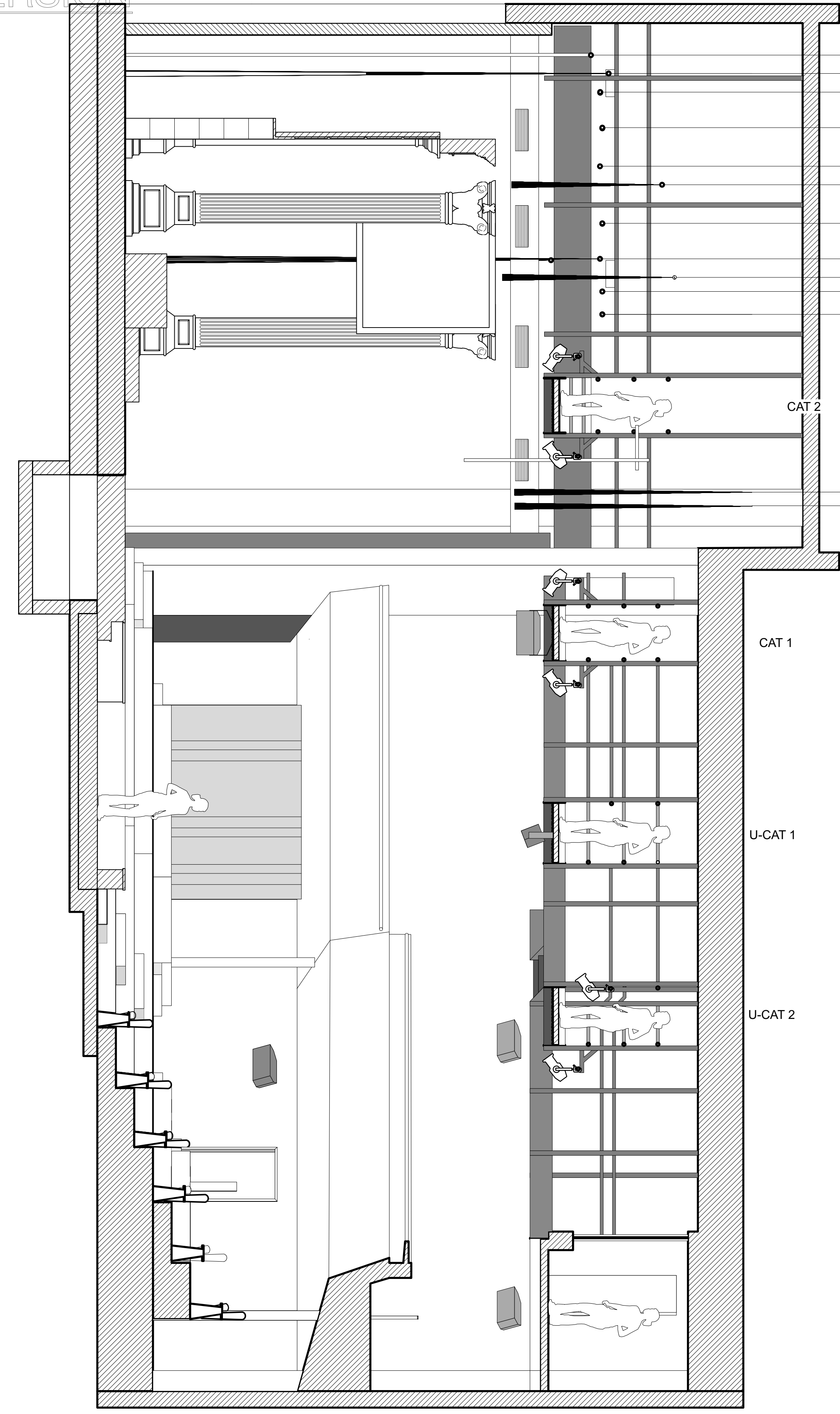
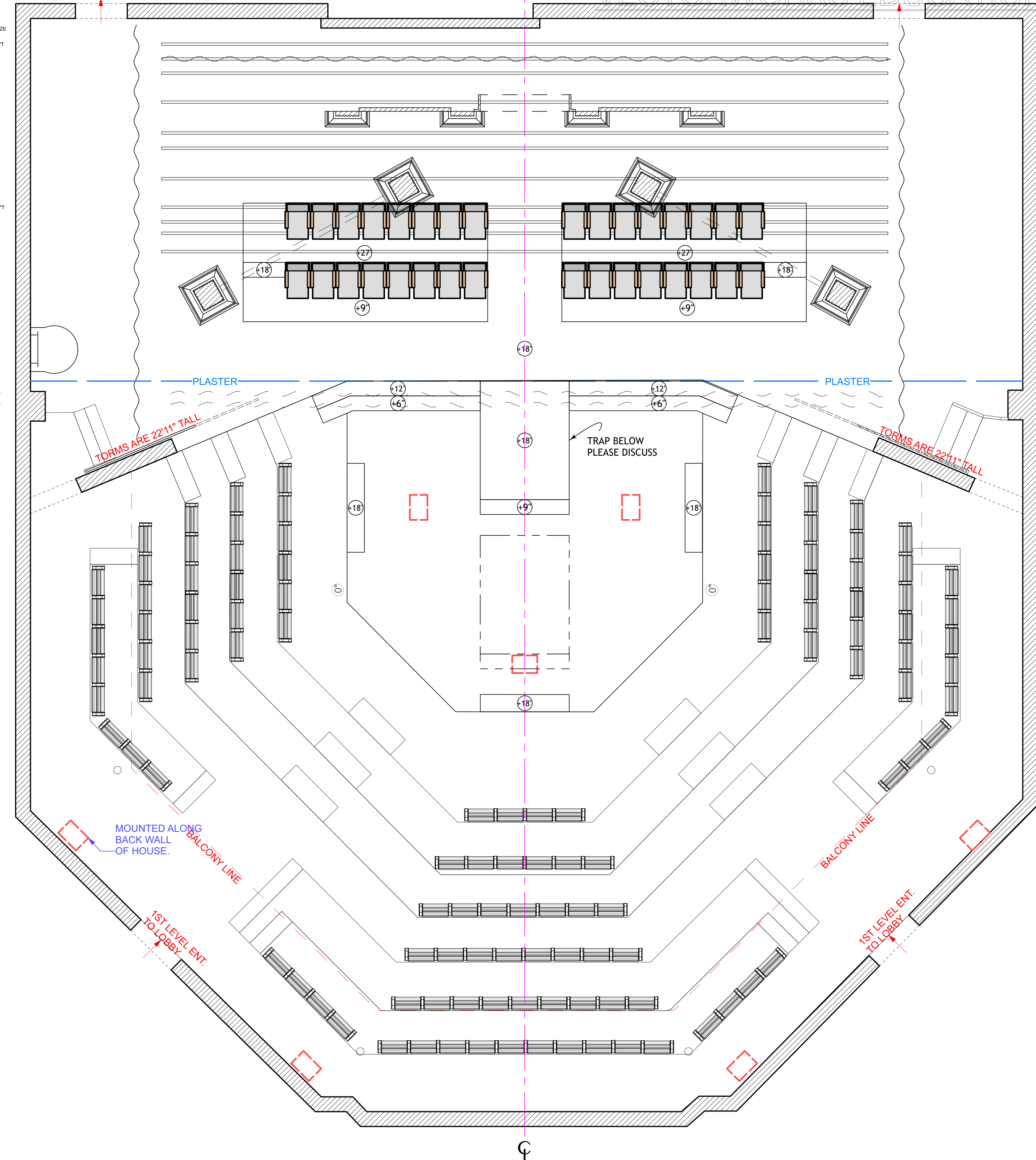

<p>S.D. 4561 SCENIC DESIGNER</p>	<b>JULIUS CAESAR</b>		Plate # <div style="border: 1px solid black; border-radius: 50%; width: 40px; height: 40px; display: flex; align-items: center; justify-content: center; margin: 0 auto;">1</div> of 4
	FLOOR PLAN AND CL SECTION		
	SCALE : 1/4" = 1'-0"		
	DATE : 1/2/24	REV : 1/10/24	
	DIRECTOR : Brian Isaac Phillips		
DESIGN : Charlie Calvert	DRAWN BY : CC		
CINCINNATI SHAKESPEARE COMPANY			
OTTO M. BUDIG THEATER			

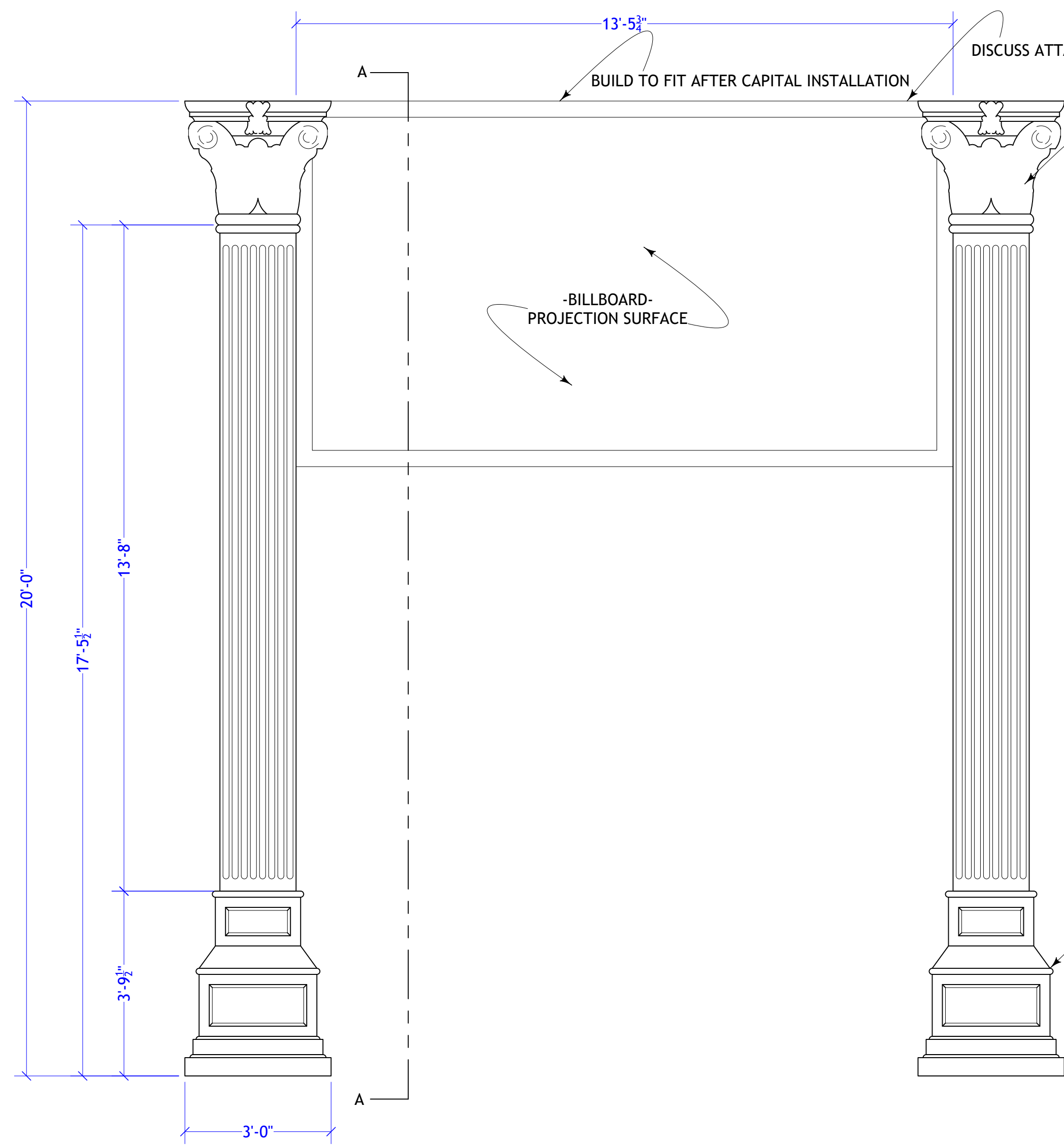

**FRONT ELEVATION**

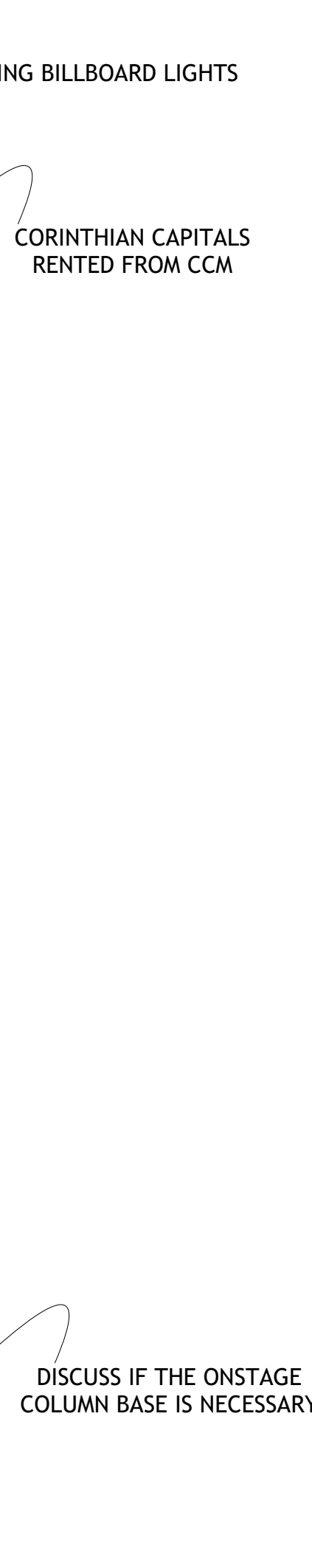

**SIDE**

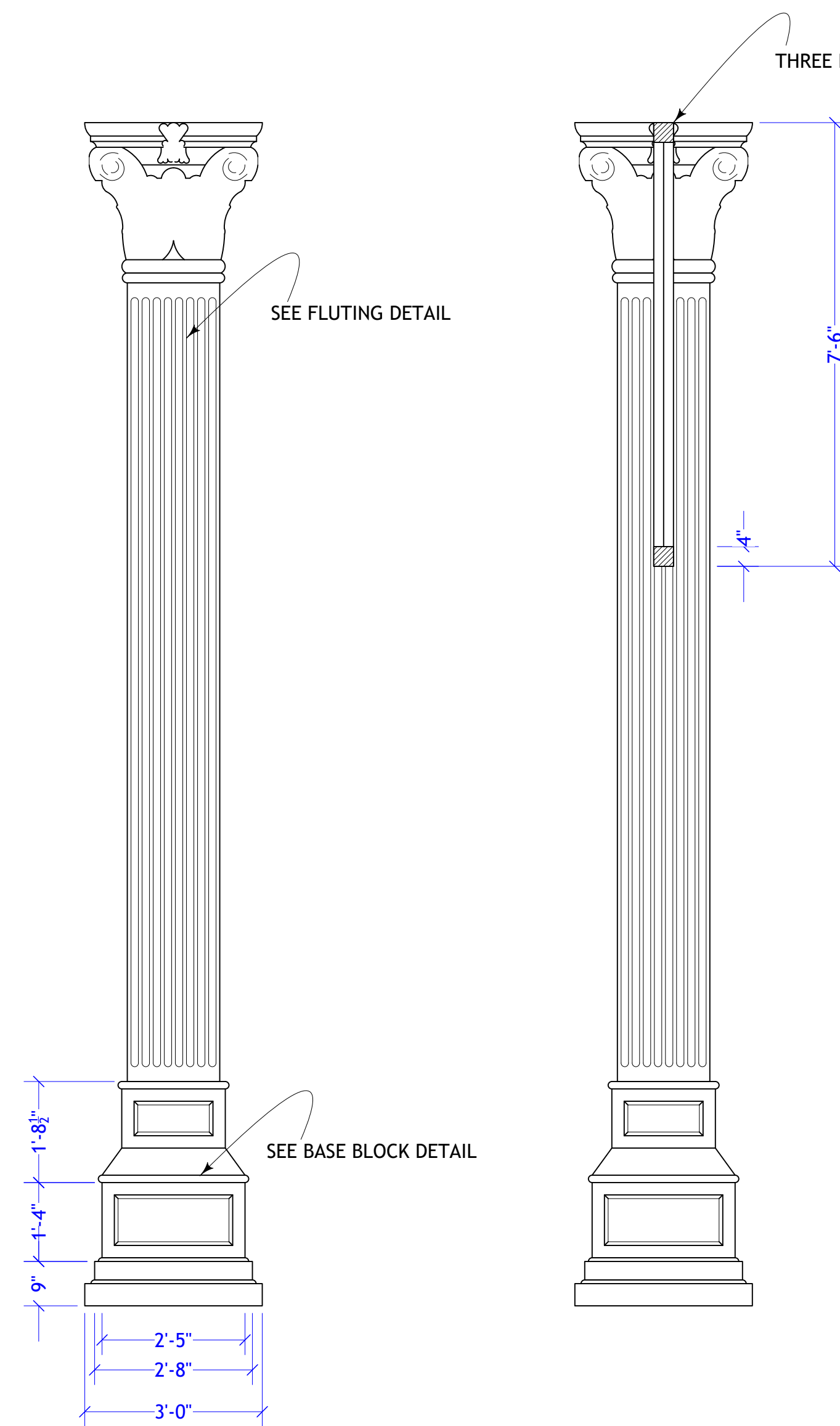

**SECTION A-A**

[https://www.htm-lighting.com/products/10-satin-black-angle-shade-with-gooseneck?variant=52003659206&utm\\_campaign=gs-2018-10-05&utm\\_source=google&utm\\_medium=smart\\_campaign&utm\\_source=1&gclid=CjwKCAiAhJWsBhAaEiwAmrNyq45rBbTEfIQxLViML780-SSy4DleXpuhT2BKNRSL7QCTrpzzwp9sRoC378QAvD\\_BwE](https://www.htm-lighting.com/products/10-satin-black-angle-shade-with-gooseneck?variant=52003659206&utm_campaign=gs-2018-10-05&utm_source=google&utm_medium=smart_campaign&utm_source=1&gclid=CjwKCAiAhJWsBhAaEiwAmrNyq45rBbTEfIQxLViML780-SSy4DleXpuhT2BKNRSL7QCTrpzzwp9sRoC378QAvD_BwE)

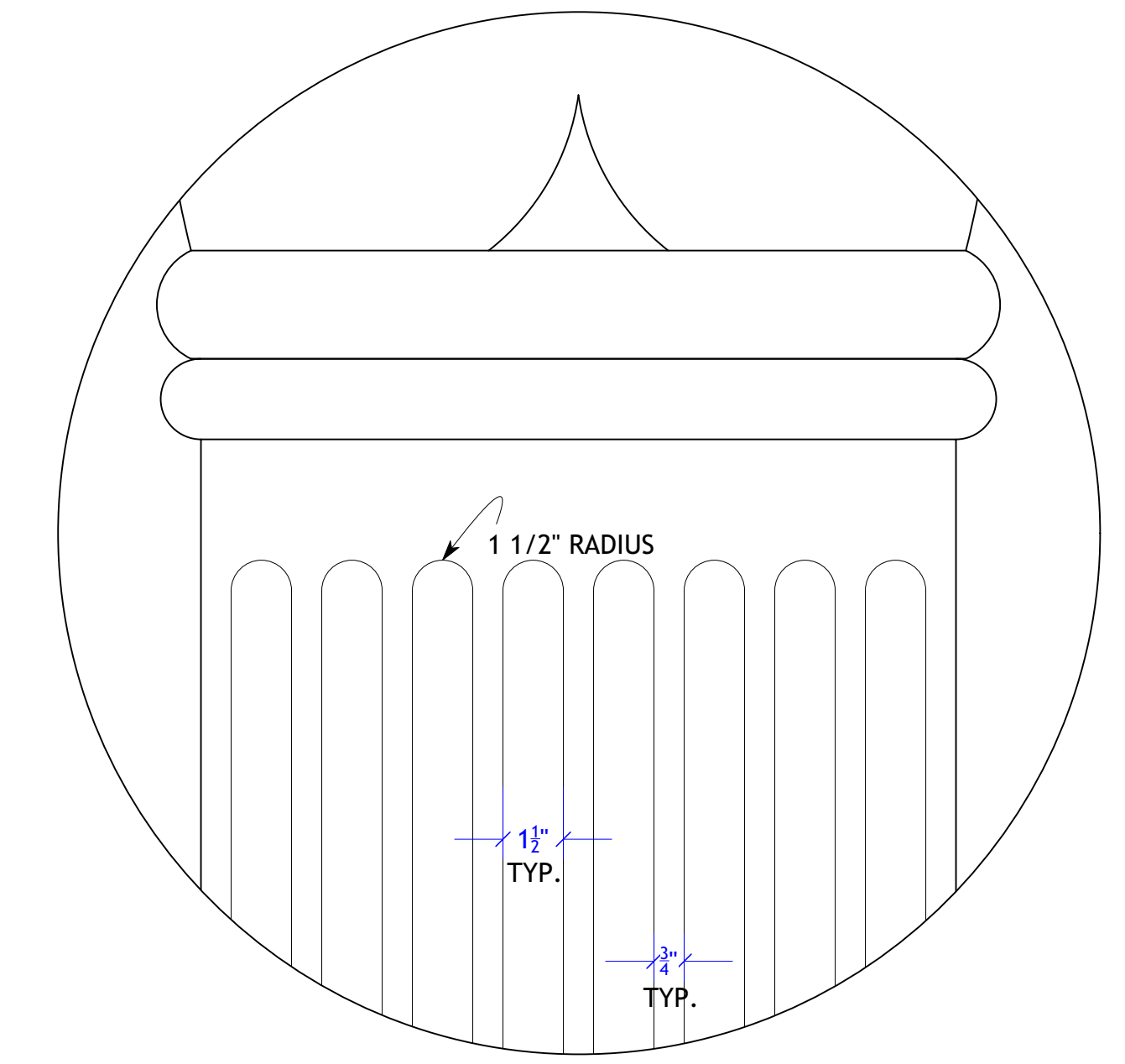

**FLUTING DETAIL**  
SCALE: 3" = 1'-0"

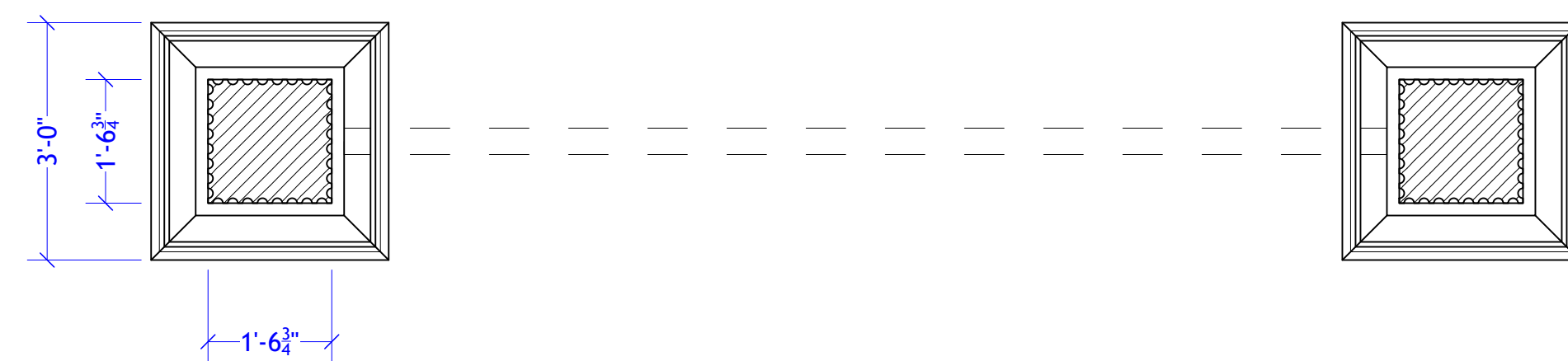

**PLAN**

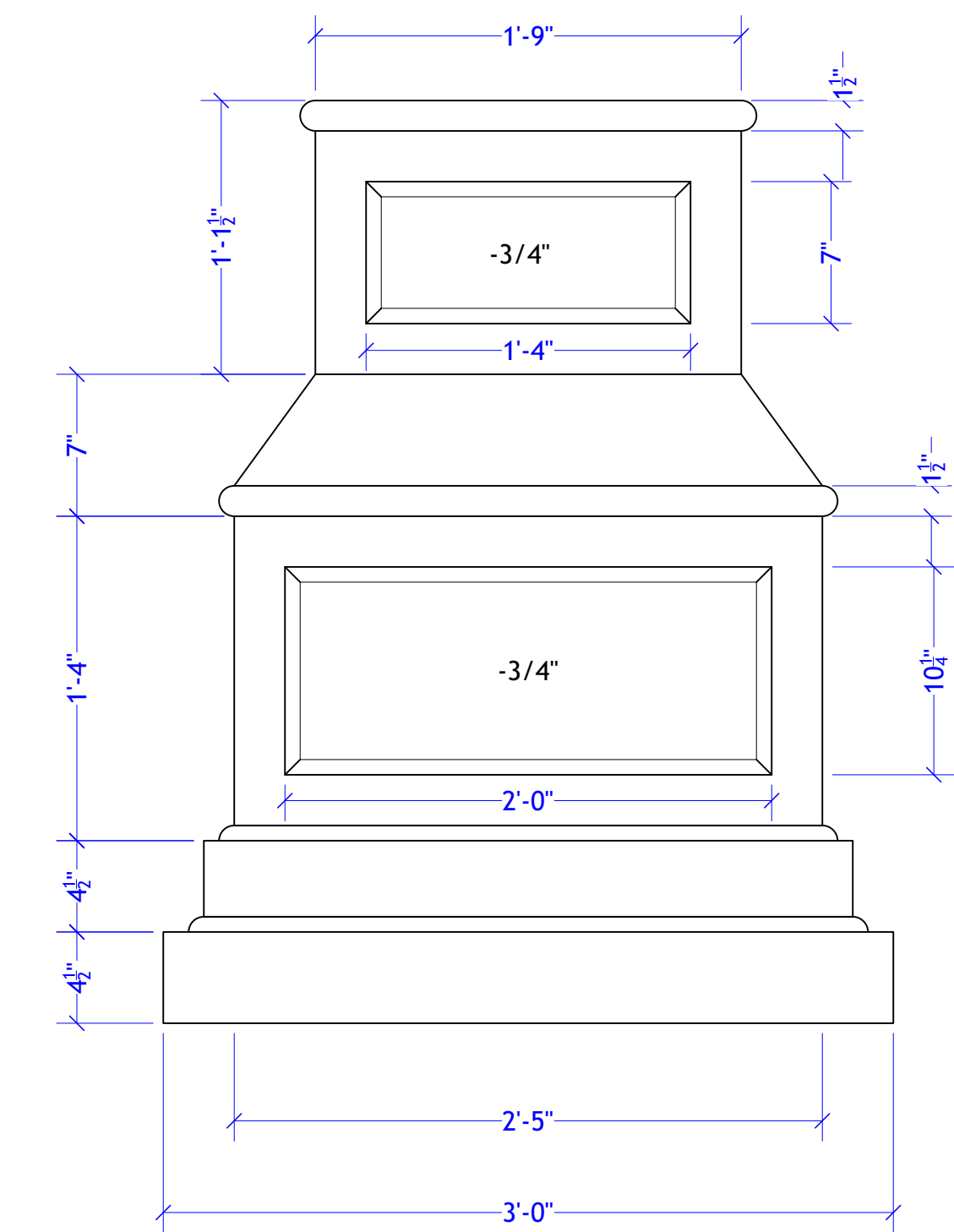

**BASE BLOCK DETAIL**  
SCALE: 1 1/2" = 1'-0"

**SR COLUMNS AND BILLBOARD**

R & R FOR SL COLUMNS AND BILLBOARD

<b>JULIUS CAESAR</b>		Plate # <b>2</b> of 4
COLUMN AND BILLBOARD SCALE: 1/2" = 1'-0" (or as noted)		
DATE: 1/2/24	REV:	
DIRECTOR: Brian Isaac Phillips		
DESIGN: Charlie Calvert	DRAWN BY: CC	
S.D. 4561 SCENIC DESIGNER	CINCINNATI SHAKESPEARE COMPANY OTTO M. BUDIG THEATER	

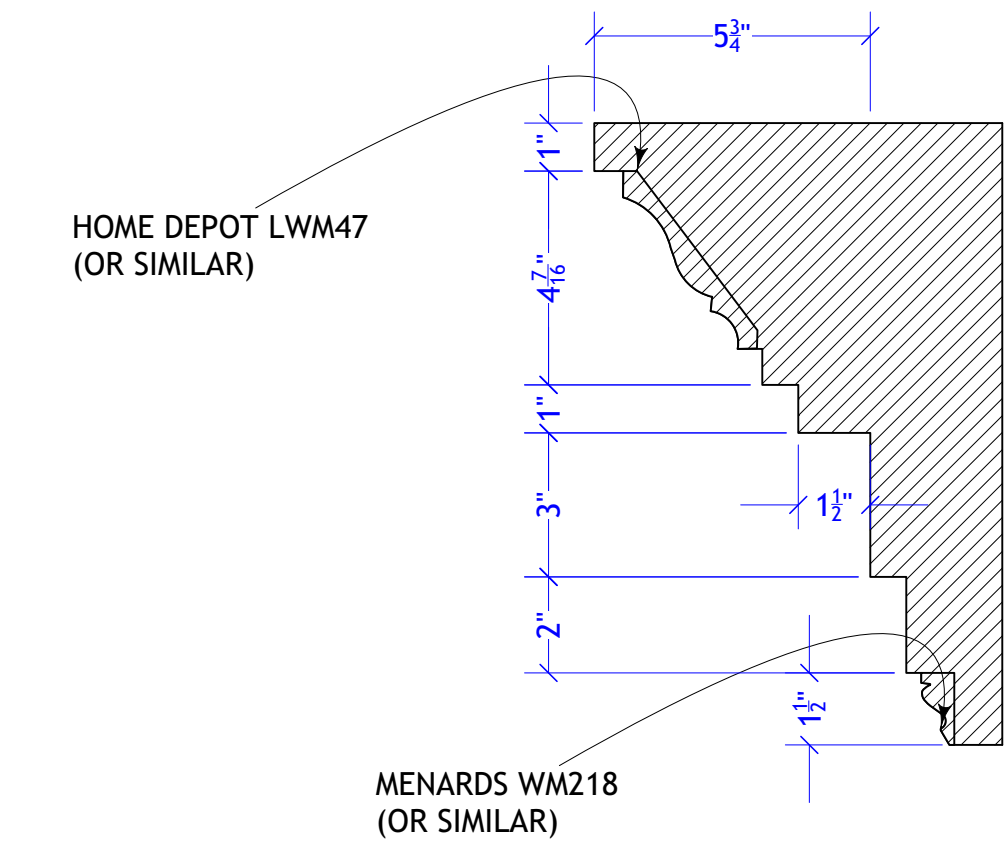
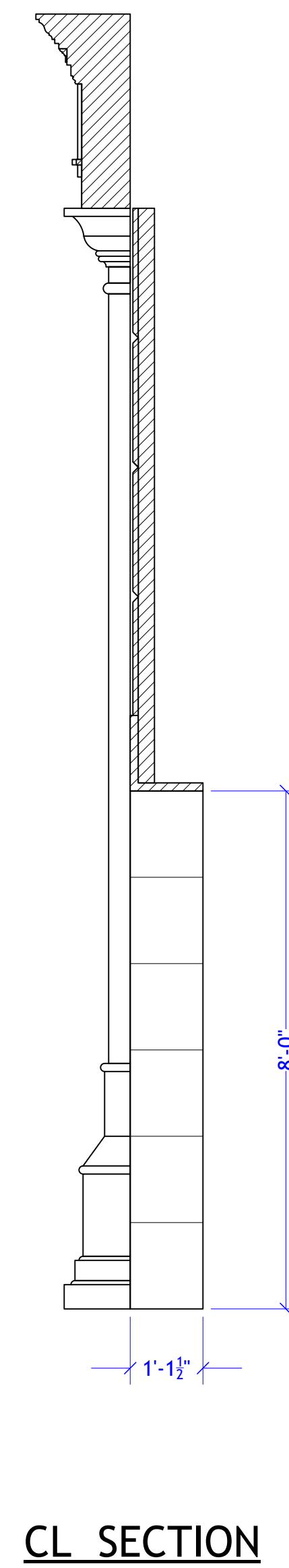
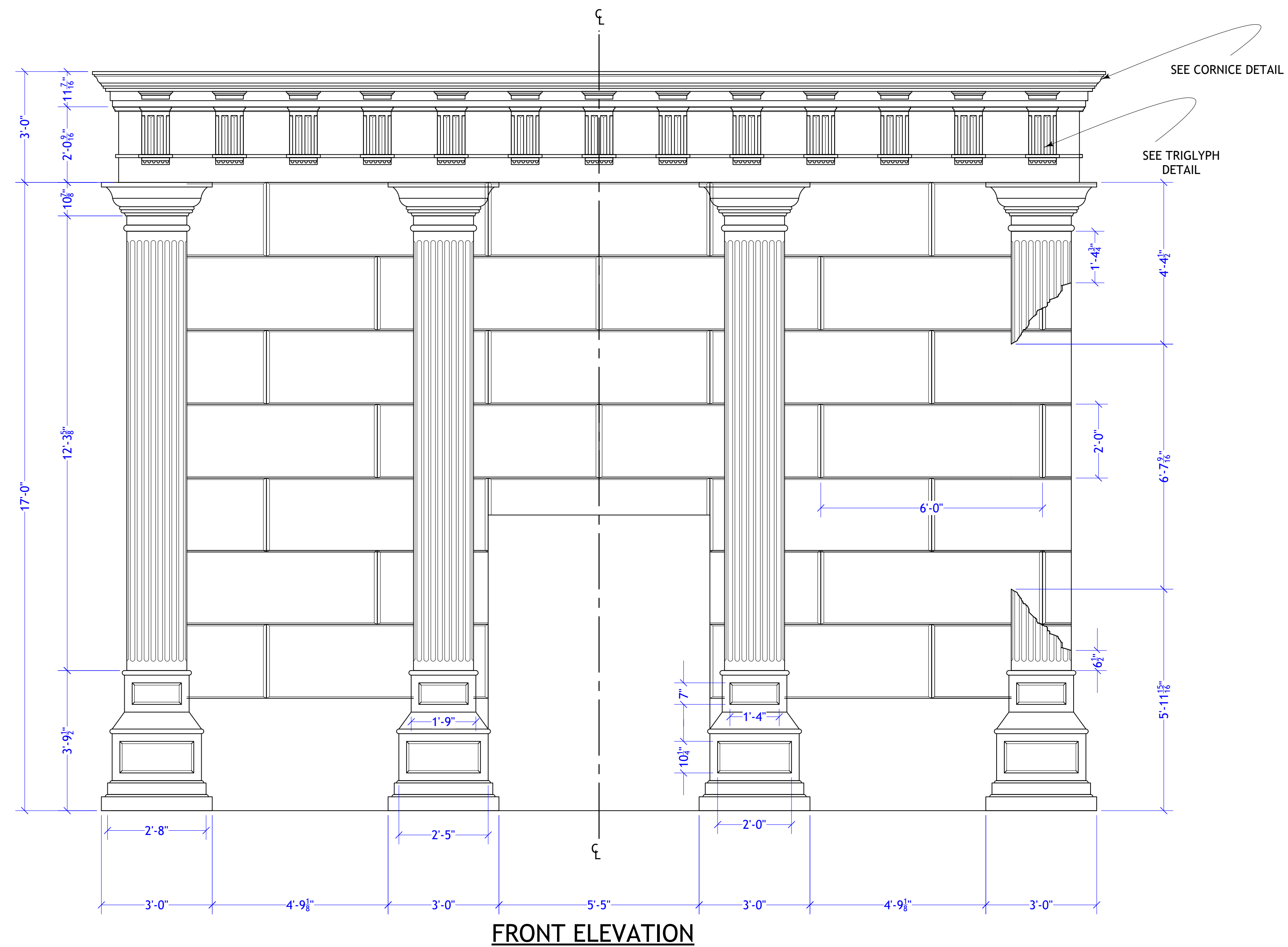

SCALE: 3" = 1'-0"

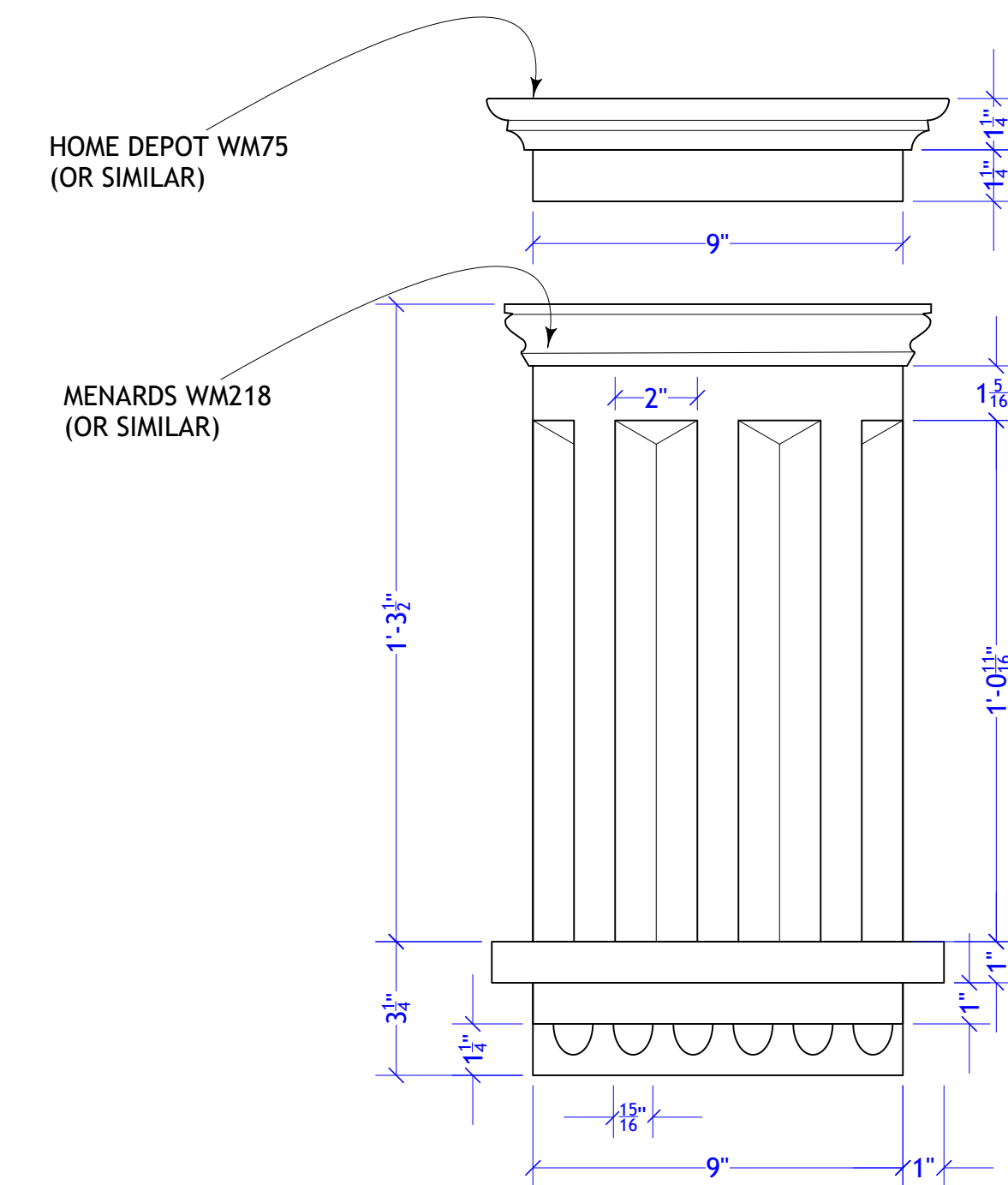

SCALE: 3" = 1'-0"

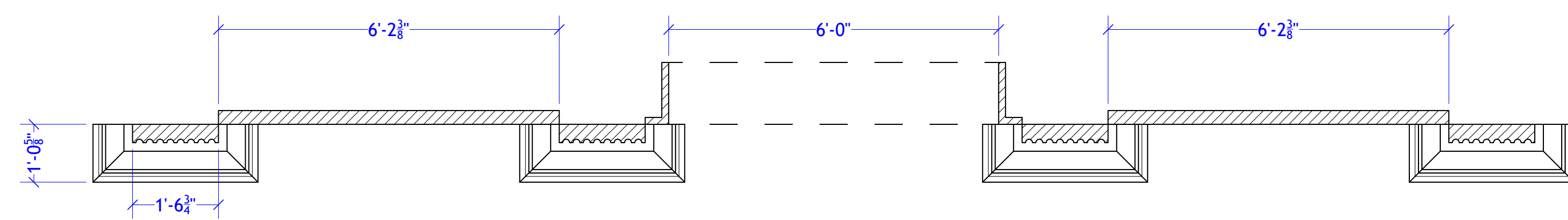

**BACK WALL**

<b>JULIUS CAESAR</b>		Plate # <b>3</b> of 4
BACK WALL SCALE: 1/2" = 1'-0" (or as noted)		
DATE: 1/2/24	REV: 1/10/24	
DIRECTOR: Brian Isaac Phillips		
DESIGN: Charlie Calvert	DRAWN BY: CC	
CINCINNATI SHAKESPEARE COMPANY OTTO M. BUDIG THEATER		

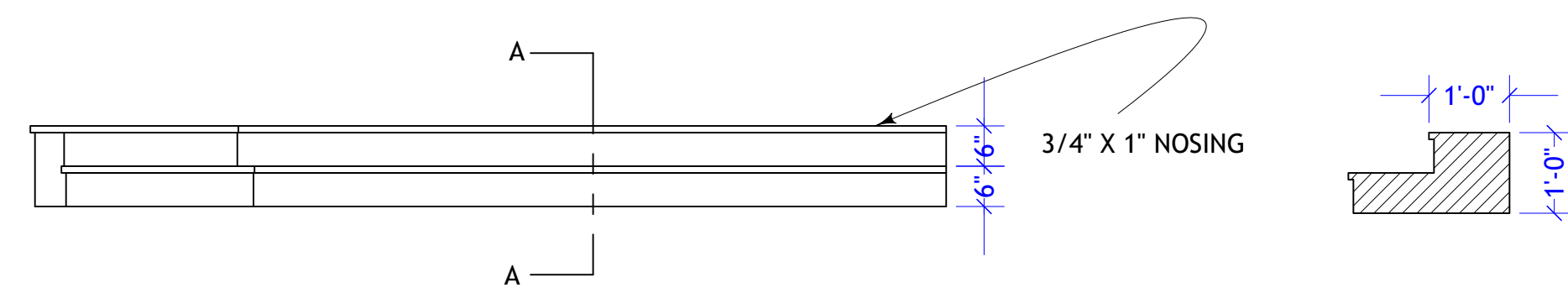

FRONT ELEVATION

SECTION A-A

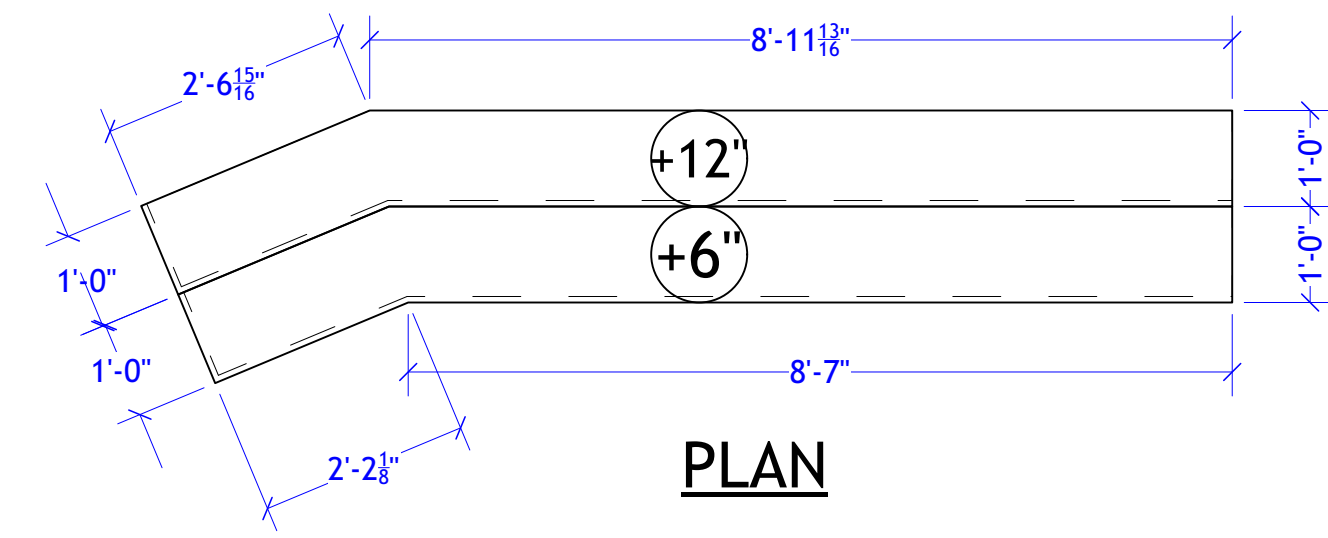

PLAN

BUILD TO FIT APRON

SR STAIRS

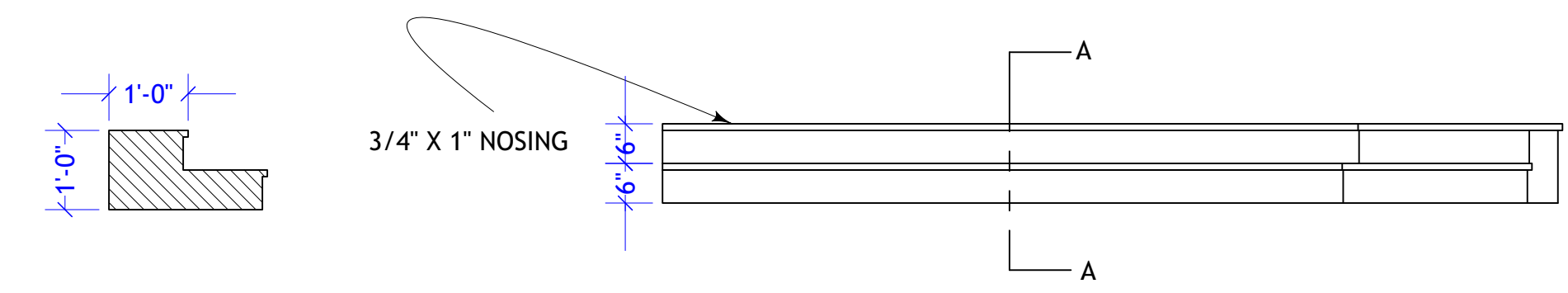

SECTION A-A

FRONT ELEVATION

BUILD TO FIT APRON

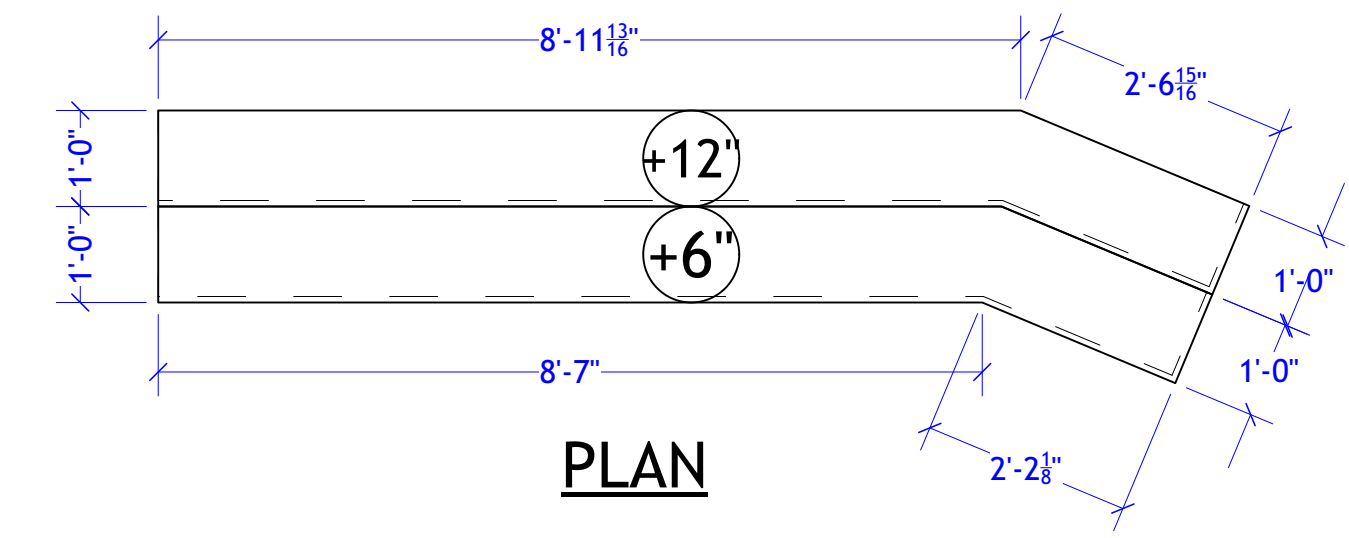

PLAN

SL STAIRS

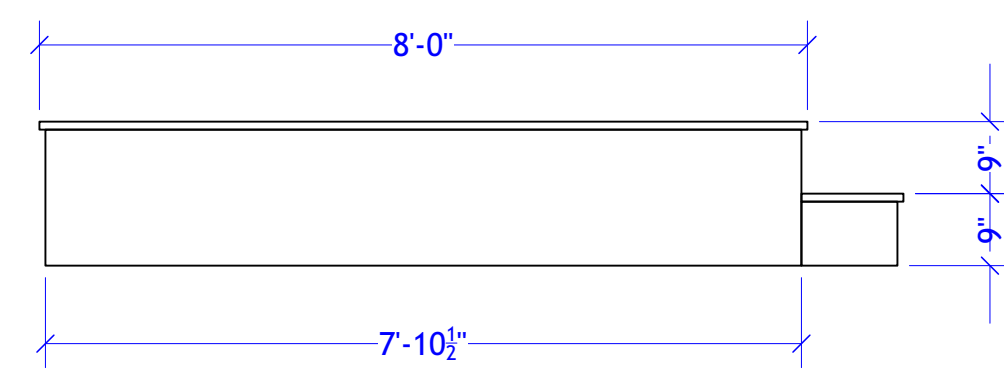

SIDE

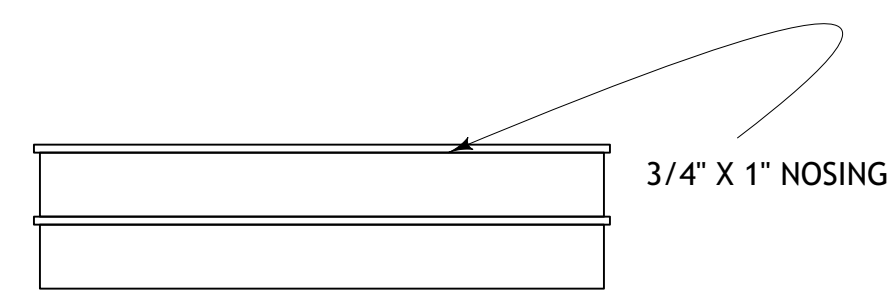

FRONT ELEVATION

UNIT TRACKS UP AND DOWNSTAGE

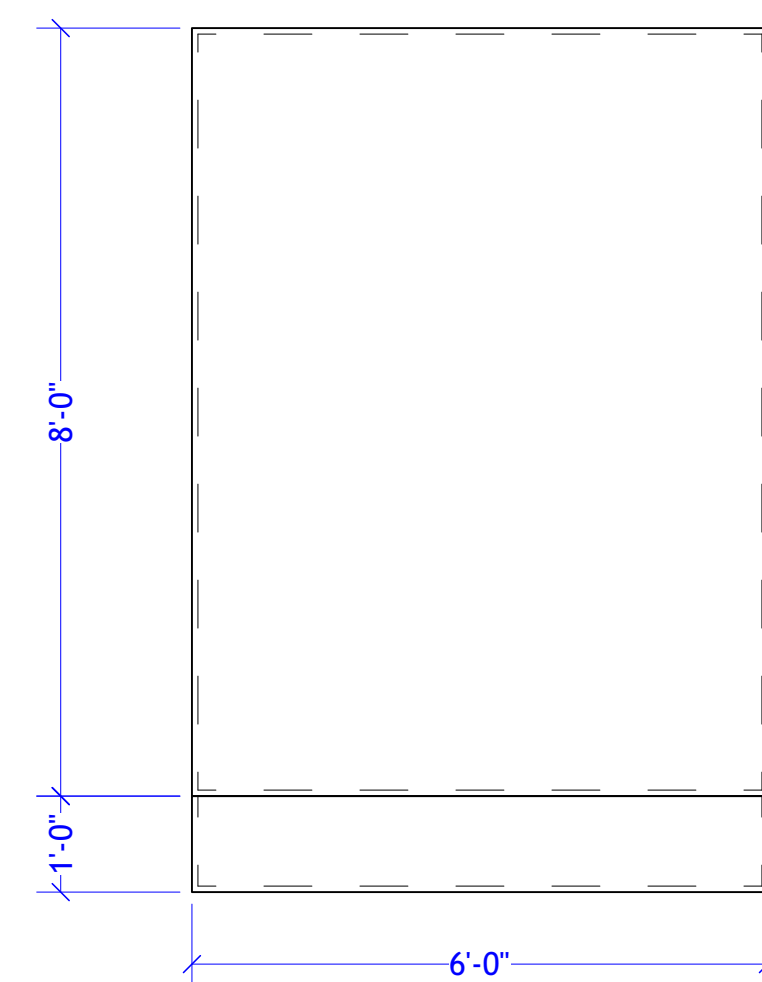

PLAN

TRACKING DECK

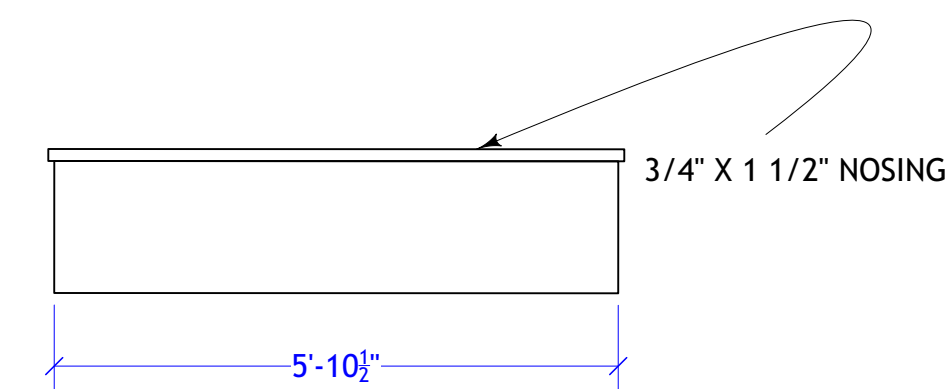

FRONT ELEVATION

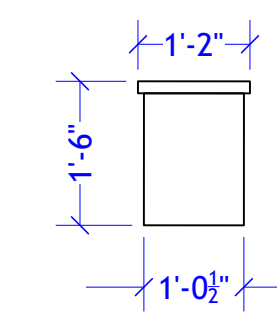

SIDE

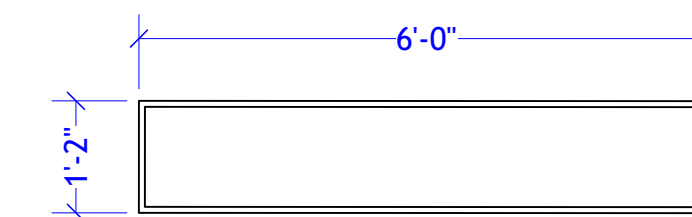

PLAN

BUILD THREE

MOBILE BENCH

<b>JULIUS CAESAR</b>			Plate # <b>4</b>
MISC. ELEVATIONS			
SCALE : 1/2" = 1'-0"			
DATE : 1/2/24	REV :		
DIRECTOR : Brian Isaac Phillips			
DESIGN : Charlie Calvert	DRAWN BY : CC		
S.D. 4561 SCENIC DESIGNER	CINCINNATI SHAKESPEARE COMPANY OTTO M. BUDIG THEATER		